

KDCP

REGULAR SLOTTED CASE (RSC)  
& PARTIAL OVERLAPPED (POL)

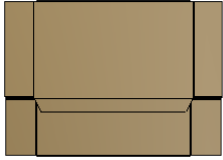

REGULAR SLOTTED  
CASE (RSC)

END LOAD

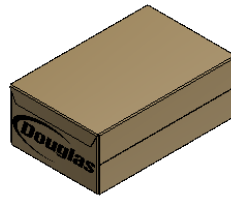
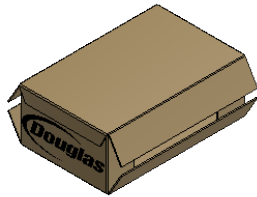
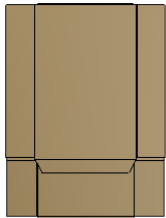

REGULAR SLOTTED  
CASE (RSC)

SIDE LOAD

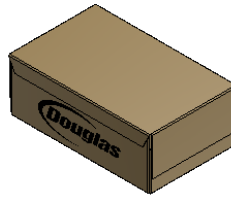
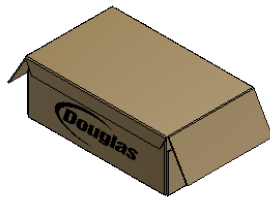
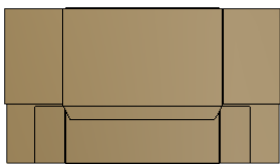

PARTIAL OVERLAPPED  
CASE (POL)

END LOAD

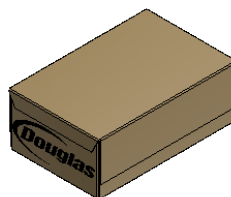
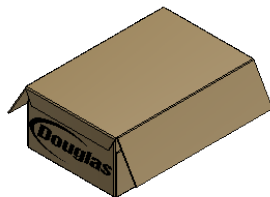
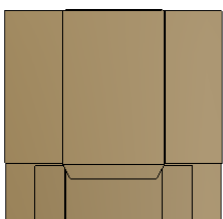

PARTIAL OVERLAPPED  
CASE (POL)

SIDE LOAD

KDCP  
FULLY OVERLAPPED (FOL)  
REVERSE FLAP FOLDING

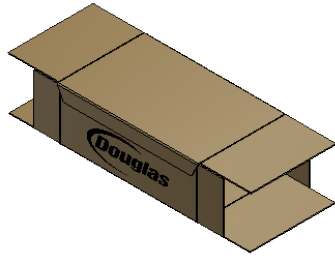
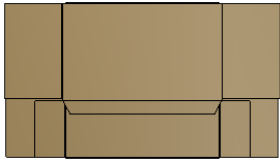

FULLY OVERLAPPED  
CASE (FOL)

END LOAD

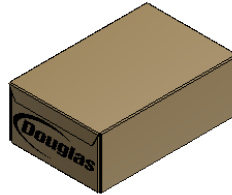
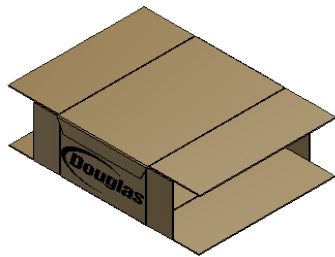
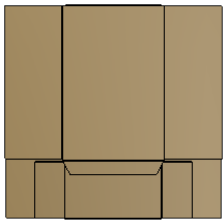

FULLY OVERLAPPED  
CASE (FOL)

SIDE LOAD

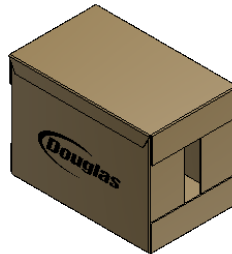
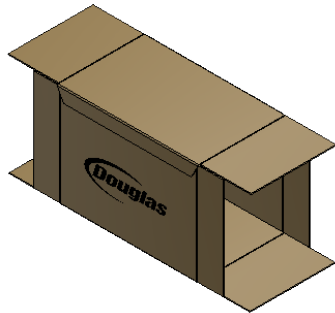
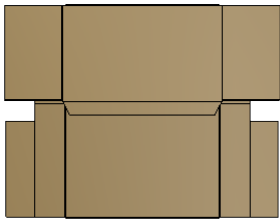

REGULAR SLOTTED  
CASE (RSC)  
WITH REVERSE  
FLAP FOLDING

END LOAD

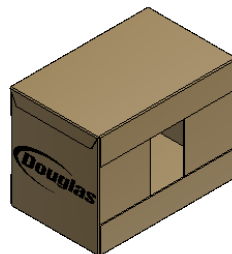
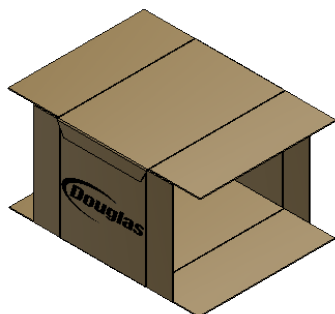
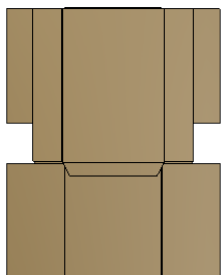

REGULAR SLOTTED  
CASE (RSC)  
WITH REVERSE  
FLAP FOLDING

SIDE LOAD

COBS (KD)  
REGULAR SLOTTED CASE (RSC)

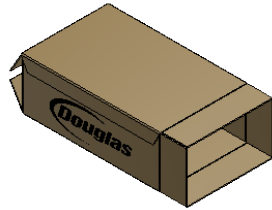
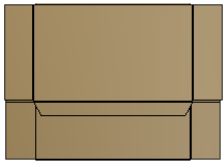

REGULAR SLOTTED  
CASE (RSC)

FOR LH MACHINE

END LOAD

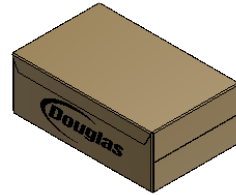
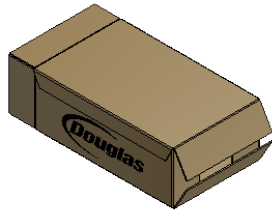
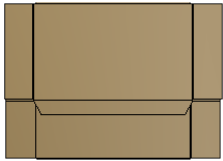

REGULAR SLOTTED  
CASE (RSC)

FOR RH MACHINE

END LOAD

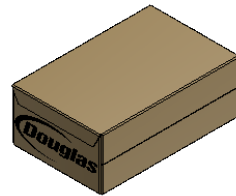
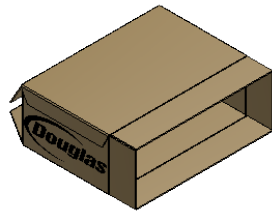
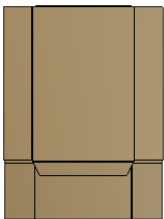

REGULAR SLOTTED  
CASE (RSC)

FOR LH MACHINE

SIDE LOAD

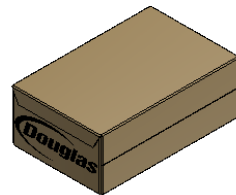
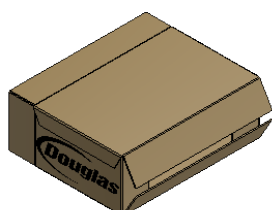
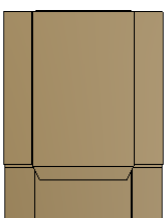

REGULAR SLOTTED  
CASE (RSC)

FOR RH MACHINE

SIDE LOAD

COBS (KD)  
PARTIAL OVERLAPPED (POL)

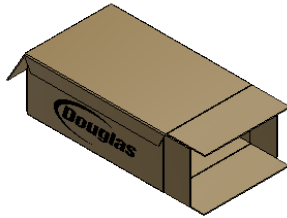
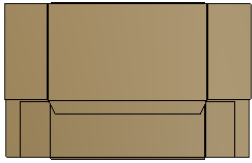

PARTIAL OVERLAPPED  
CASE (POL)  
FOR LH MACHINE  
END LOAD

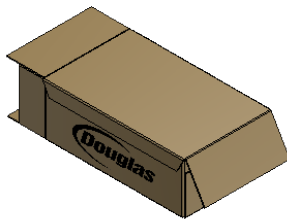
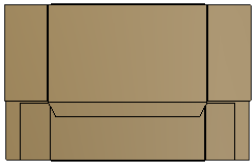

PARTIAL OVERLAPPED  
CASE (POL)  
FOR RH MACHINE  
END LOAD

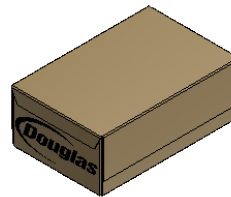
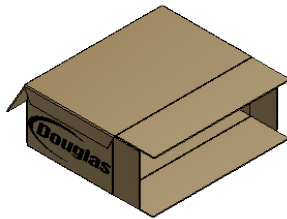
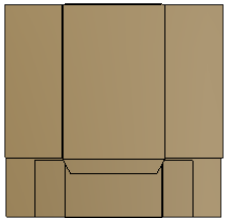

PARTIAL OVERLAPPED  
CASE (POL)  
FOR LH MACHINE  
SIDE LOAD

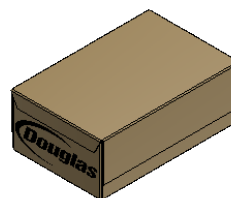
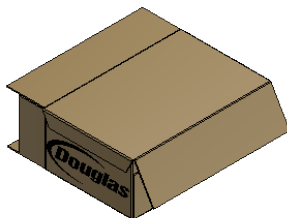
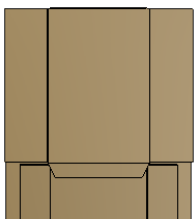

PARTIAL OVERLAPPED  
CASE (POL)  
FOR RH MACHINE  
SIDE LOAD

COBS  
FULLY OVERLAPPED (FOL)

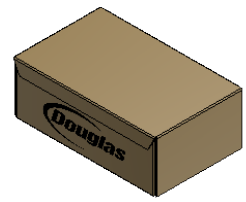
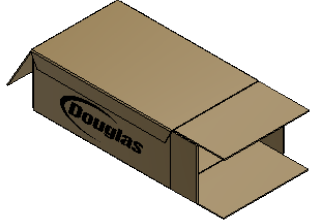
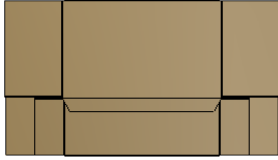

FULLY OVERLAPPED  
CASE (FOL)  
FOR LH MACHINE  
END LOAD

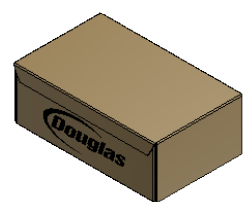
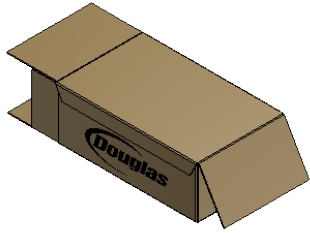
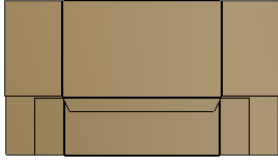

FULLY OVERLAPPED  
CASE (FOL)  
FOR RH MACHINE  
END LOAD

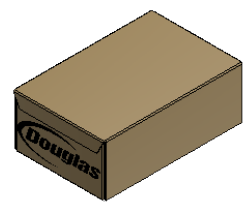
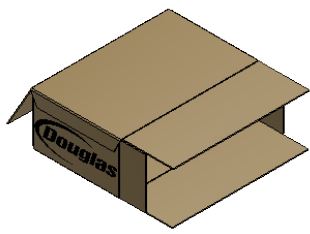
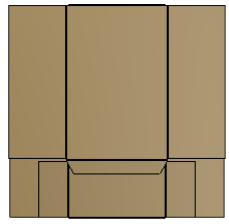

FULLY OVERLAPPED  
CASE (FOL)  
FOR LH MACHINE  
SIDE LOAD

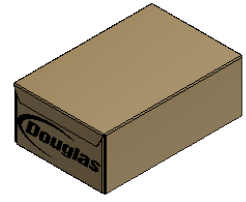
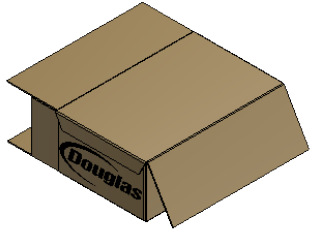
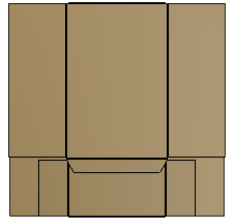

FULLY OVERLAPPED  
CASE (FOL)  
FOR RH MACHINE  
SIDE LOAD

COBS  
REGULAR SLOTTED CASE (RSC)  
WITH REVERSE FLAP FOLDING

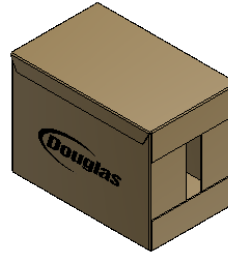
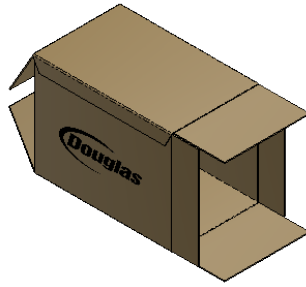
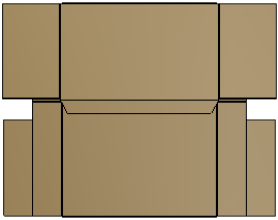

REGULAR SLOTTED  
CASE (RSC)  
WITH REVERSE  
FLAP FOLDING

FOR LH MACHINE

END LOAD

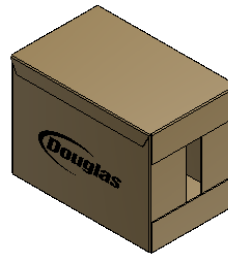
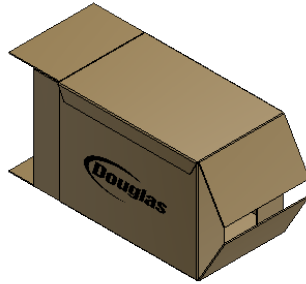
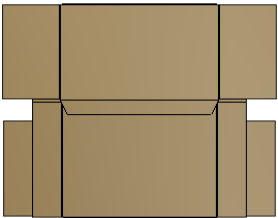

REGULAR SLOTTED  
CASE (RSC)  
WITH REVERSE  
FLAP FOLDING

FOR RH MACHINE

END LOAD

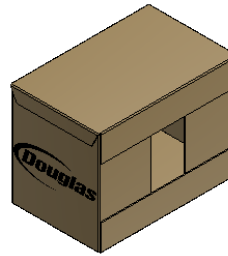
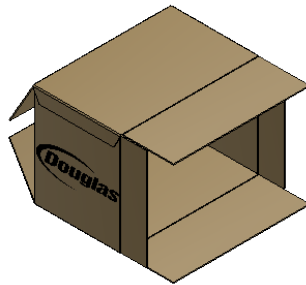
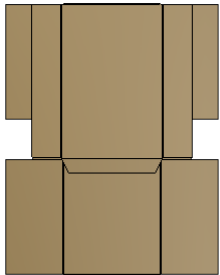

REGULAR SLOTTED  
CASE (RSC)  
WITH REVERSE  
FLAP FOLDING

FOR LH MACHINE

SIDE LOAD

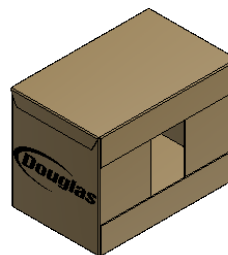
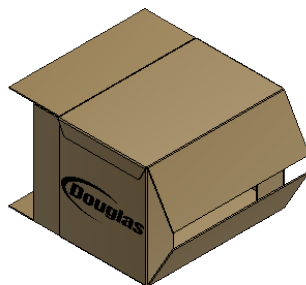
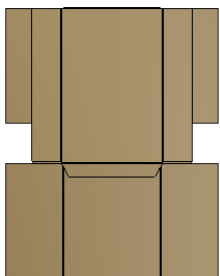

REGULAR SLOTTED  
CASE (RSC)  
WITH REVERSE  
FLAP FOLDING

FOR rH MACHINE

SIDE LOAD